

Vacuum hose (meter)

## VSL 8-6 PU MI-TR



Art.-Nr.: 10.07.09.00003



### Technical data

Material hose	PU
Bending radius min.	45.0 mm
Color	Milky-transparent
Length max.	500.00 m
Pressure range (operating pressure) [bar]	-0.95 ... 10.00 bar
Operating temperature	-35 ... 60 °C
Outside diameter D	8.00 mm
Internal diameter d	6.00 mm

VSL 8-6 PU MI-TR

Vacuum/compressed air hose VSL is delivered in the desired length.

Available accessories: hose clamp

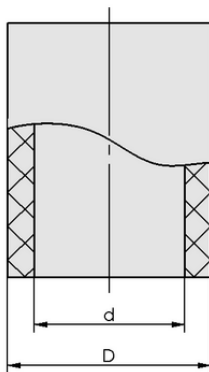

### Design data

Outside diameter D	8.00 mm
Internal diameter d	6.00 mm

Design data VSL 8-6 PU MI-TR



[WWW.SCHMALZ.COM/10.07.09.00003](http://WWW.SCHMALZ.COM/10.07.09.00003)

1

Art.-Nr.: 10.07.09.00003

**Technical data**

Material hose	PU
Bending radius min.	45.0 mm
Length max.	500.00 m
Pressure range (operating pressure) [bar]	-0.95 ... 10.00 bar
Operating temperature	-35 ... 60 °C
Weight / Meter	0.027 kg/m
Product family	VSL
Design hose type	8-6

Note: Operating pressure: In reference to media and ambient temperature of + 20 °C Min. bending radius: Referred to the inner side of the hose bend in a static state Max. length: Please indicate the tube length when placing the order!

**Ordering Data Accessories 10.07.09.00003**

Typ		Item number
Hose sleeve	ST G1/4-AG 6 MS-V	10.08.03.00156
Hose sleeve	ST G1/8-AG 6 MS-V	10.08.03.00154
Plug union, straight	STV-GE G1/4-AG 8	10.08.02.00207
Plug union, straight	STV-GE G1/8-AG 8	10.08.02.00206
Plug union, straight	STV-GE G3/8-AG 8	10.08.02.00237
Plug union, straight	STVI-GE G1/4-IG 8	10.08.02.00154
Plug union, straight	STVI-GE G1/8-IG 8	10.08.02.00151
Plug union, T	STV-T G1/4-AG 8	10.09.02.00043
Plug union, T	STV-T G1/8-AG 8	10.09.02.00041
Plug union, elbow	STV-W G1/4-AG 8	10.08.02.00161
Plug union, elbow	STV-W G1/8-AG 8	10.08.02.00160
Plug union, elbow	STV-W G3/8-AG 8	10.08.02.00236
Plug union, elbow	STV-WF G1/4-AG 8	10.08.02.00171
Plug union, elbow	STV-WF G1/8-AG 8	10.08.02.00170
Plug union, elbow	STV-WF G3/8-AG 8	10.08.02.00234
Plug connector, T	SVB-T 8	10.09.02.00022

