



## Technical data

Attribute	Value
Construction vacuum switch	with display
Electrical connection	Male connect M12, 4 pol
Protection type IP	IP 65
Indication	2xLED
Measuring range [bar]	-1,0 ... 8,0 bar

VSi VP8 D M12-4

Vacuum and pressure switch VSi is delivered as a ready-to-connect product (without connection cable). The product consists of:

- Vacuum and pressure switch of type VSi - available as vacuum version, pressure version or combined version without display or with integrated display

Available accessories: connection cable, mounting bracket

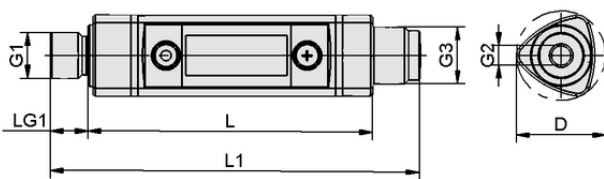

## Design data

Attribute	Value
Length L1	78.50 mm
Length L	60.50 mm
Outside diameter D	19.60 mm
Thread G1	G1/8"-M
Thread length LG1	8.0 mm
Thread G2	M5-F
Thread G3	M12x1-M

Design data VSi VP8 D M12-4

Vacuum/pressure switch  
**VSi VP8 D M12-4**



Art.-Nr.: 10.06.02.00582



**Technical data**

Attribute	Value
Construction vacuum switch	with display
Inputs / outputs	2 digital
Electrical connection	Male connect M12, 4 pol
Protection type IP	IP 65
Max. overpressure safety	174.04 psi
Current consumption	35.00 mA
Weight	16.00 g
Indication	2xLED
Hysteresis	Adjustable
Measured medium	Non-aggressive gases; dry, oil-free air
Repeatability	± 3% of full-scale value
Switching capacity max.	100 mA
Connection	G1/8"-M + M5-F
Measuring range [bar]	-1,0 ... 8,0 bar
Operating temperature	0 ... 50 °C
Measuring range	-14.5 ... 116.0 psi
Product family	VSi
Voltage	10-30V DC



**Further documentation**

CAD data and other documents relating to the article can be found at: [www.schmalz.com/10.06.02.00582](http://www.schmalz.com/10.06.02.00582)



**Ordering Data Accessories 10.06.02.00582**

Typ		Item number
Connection cable	ASK B-M12-4 5000 K-4P	21.04.05.00263
Mounting bracket	BEF-WIN 21x22x60.5 1.5 VS	10.06.02.00061
Connection cable	ASK WB-M12-5 5000 K-4P	21.04.05.00557
Plug union, straight	STVI-GE G1/8-IG 4	10.08.02.00149
Plug union, straight	STVI-GE G1/8-IG 6	10.08.02.00150
Plug union, straight	STVI-GE G1/8-IG 8	10.08.02.00151
Holder VSi	HTR-VSi Clip	10.06.02.00718
Mounting bracket	BEF-WIN 21x22x61.5 1.5 VSi-D-M12	10.06.02.00663



[WWW.SCHMALZ.COM/10.06.02.00582](http://WWW.SCHMALZ.COM/10.06.02.00582)