

Compact ejector  
**SCP 30 NC AS RD**

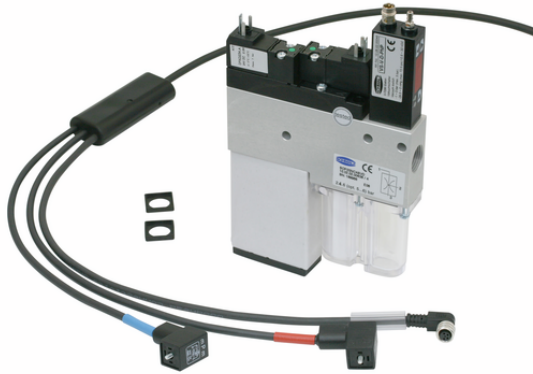

Art.-Nr.: 10.02.02.00789



**Technical data**

Attribute	Value
Nozzle diameter	3.0 mm
Air consumption suction	420.0 l/min
Suction rate (max.)	200.0 l/min
Pressure range (operating pressure) [bar]	5.0 ... 6.0 bar
Shape compact ejectors	With blow-off system
Control valve	Normally closed
Operation mode	Digital air-saving function

SCP 30 NC AS RD

Compact ejector SCP is delivered as a ready to connect product (without connection cable).

Available spare parts: silencer box, filter element

Available accessories: connection cable, connection plug

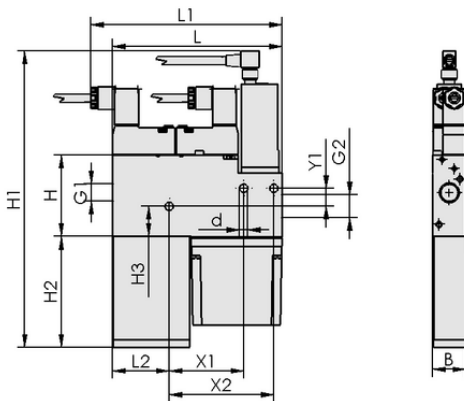

**Design data**

Attribute	Value
Length L2	37.50 mm
Length L	112.50 mm
Width B	22.00 mm
Height H1	196.50 mm
Height H2	73.50 mm
Height H	54.00 mm
Internal diameter d	5.50 mm
Thread G1	G1/4"-F
Thread G2	G3/8"-F
Height H3	20.10 mm
Hole spacing Y1	12.0 mm
Hole spacing X1	49.5 mm
Hole spacing X2	69.5 mm

Design data SCP 30 NC AS RD



[WWW.SCHMALZ.COM/10.02.02.00789](http://WWW.SCHMALZ.COM/10.02.02.00789)

Compact ejector  
**SCP 30 NC AS RD**



Art.-Nr.: 10.02.02.00789



**Technical data**

Attribute	Value
Nozzle diameter	3.0 mm
Degree of evacuation	85.0 %
Suction rate (max.)	7.062 cfm
Product family	SCP
Control valve	Normally closed

Note: The supply voltage for vacuum switches and solenoid valves is 24V DC Air consumption: At optimal operating pressure Hose diameter: For max. length 2 m



**Further documentation**

CAD data and other documents relating to the article can be found at: [www.schmalz.com/10.02.02.00789](http://www.schmalz.com/10.02.02.00789)



**Ordering Data Spare Parts 10.02.02.00789**

Typ		Item number
Filter insert (round)	FILT-EINS 50 14x49 PE-POR SCP-SMP	10.02.02.00654
Silencer (cube-shaped)	SD 50.5x21x68.5 SMP/SCP25/30	10.02.02.00652



[WWW.SCHMALZ.COM/10.02.02.00789](http://WWW.SCHMALZ.COM/10.02.02.00789)