

Compact ejector
SCP 25 NC AS VD



Art.-Nr.: 10.02.02.00638



Technical data

| | |
|---|-----------------------|
| Nozzle diameter | 2.5 mm |
| Air consumption suction | 310.0 l/min |
| Suction rate (max.) | 161.0 l/min |
| Pressure range (operating pressure) [bar] | 5.0 ... 6.0 bar |
| Shape compact ejectors | With blow-off system |
| Control valve | Normally closed |
| Operation mode | digital vacuum switch |

SCP 25 NC AS VD

Compact ejector SCP is delivered as a ready to connect product (without connection cable).

Available spare parts: silencer box, filter element

Available accessories: connection cable, connection plug

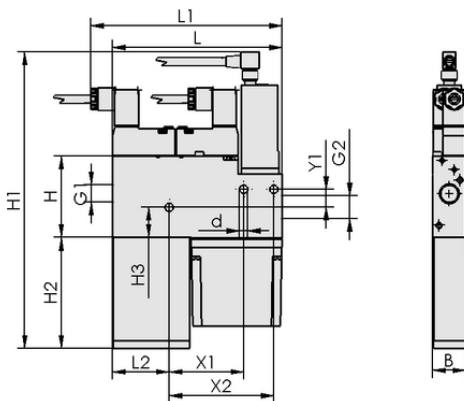

Design data

| | |
|---------------------|-----------|
| Length L2 | 37.50 mm |
| Length L | 112.50 mm |
| Width B | 22.00 mm |
| Height H1 | 196.50 mm |
| Height H2 | 73.50 mm |
| Height H | 54.00 mm |
| Internal diameter d | 5.50 mm |
| Thread G1 | G1/4"-F |
| Thread G2 | G3/8"-F |
| Height H3 | 20.10 mm |
| Hole spacing Y1 | 12.0 mm |
| Hole spacing X1 | 49.5 mm |
| Hole spacing X2 | 69.5 mm |

Design data SCP 25 NC AS VD



WWW.SCHMALZ.COM/10.02.02.00638

Compact ejector

SCP 25 NC AS VD



Art.-Nr.: 10.02.02.00638



Technical data

| | |
|----------------------|-----------------|
| Nozzle diameter | 2.5 mm |
| Degree of evacuation | 85.0 % |
| Suction rate (max.) | 5.685 cfm |
| Product family | SCP |
| Control valve | Normally closed |

Note: The supply voltage for vacuum switches and solenoid valves is 24V DC Air consumption: At optimal operating pressure Hose diameter: For max. length 2 m



Ordering Data Accessories 10.02.02.00638

| Typ | | Item number |
|------------------|------------------------|----------------|
| Connection cable | ASK B-Form-C 5000 K-3P | 21.04.06.00084 |
| Connection cable | ASK B-M8-4 5000 K-4P | 10.06.02.00031 |
| Connection cable | ASK WB-M8-4 5000 K-4P | 10.06.02.00032 |
| Connection cable | ASK 10000 K-3P | 21.04.06.00118 |
| Connection plug | ASS B-C SK | 21.04.06.00085 |



Ordering Data Spare Parts 10.02.02.00638

| Typ | | Item number |
|------------------------|-----------------------------------|----------------|
| Filter insert (round) | FILT-EINS 50 14x49 PE-POR SCP-SMP | 10.02.02.00654 |
| Silencer (cube-shaped) | SD 50.5x21x68.5 SMP/SCP25/30 | 10.02.02.00652 |



WWW.SCHMALZ.COM/10.02.02.00638