

Compact ejector
SCP 20 NO AS RD

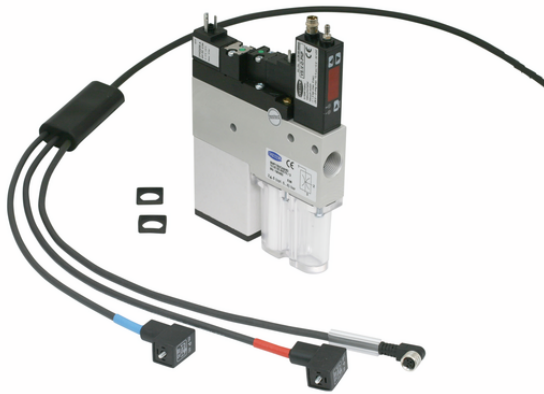

Art.-Nr.: 10.02.02.00630



SCP 20 NO AS RD

Compact ejector SCP is delivered as a ready to connect product (without connection cable).

Available spare parts: silencer box, filter element

Available accessories: connection cable, connection plug

Technical data

Attribute	Value
Nozzle diameter	2.0 mm
Air consumption suction	190.0 l/min
Suction rate (max.)	116.0 l/min
Pressure range (operating pressure) [bar]	5.0 ... 6.0 bar
Shape compact ejectors	With blow-off system
Control valve	Normally open
Operation mode	Digital air-saving function

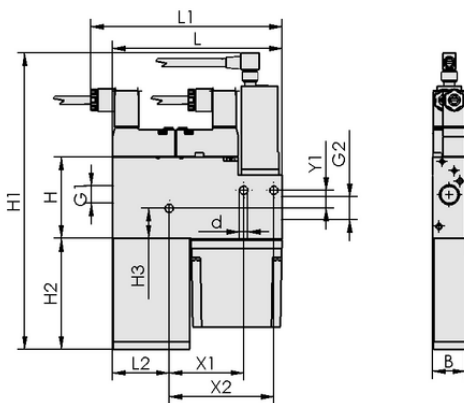

Design data SCP 20 NO AS RD

Design data

Attribute	Value
Length L2	37.50 mm
Length L	112.50 mm
Width B	22.00 mm
Height H1	181.50 mm
Height H2	58.50 mm
Height H	54.00 mm
Internal diameter d	5.50 mm
Thread G1	G1/4"-F
Thread G2	G3/8"-F
Height H3	20.10 mm
Hole spacing Y1	12.0 mm
Hole spacing X1	49.5 mm
Hole spacing X2	69.5 mm



WWW.SCHMALZ.COM/10.02.02.00630

Compact ejector
SCP 20 NO AS RD



Art.-Nr.: 10.02.02.00630



Technical data

Attribute	Value
Nozzle diameter	2.0 mm
Degree of evacuation	85.0 %
Suction rate (max.)	4.096 cfm
Product family	SCP
Control valve	Normally open

Note: The supply voltage for vacuum switches and solenoid valves is 24V DC Air consumption: At optimal operating pressure Hose diameter: For max. length 2 m



Further documentation

CAD data and other documents relating to the article can be found at: www.schmalz.com/10.02.02.00630



Ordering Data Spare Parts 10.02.02.00630

Typ		Item number
Filter insert (round)	FILT-EINS 50 14x49 PE-POR SCP-SMP	10.02.02.00654
Silencer (cube-shaped)	SD 50.5x21x53.5 SMP15/20	10.02.02.00651



WWW.SCHMALZ.COM/10.02.02.00630