

**Technical data**

| Attribute                                 | Value                 |
|---|-----------------------|
| Nozzle diameter                           | 2.0 mm                |
| Air consumption suction                   | 190.0 l/min           |
| Suction rate (max.)                       | 116.0 l/min           |
| Pressure range (operating pressure) [bar] | 5.0 ... 6.0 bar       |
| Shape compact ejectors                    | With blow-off system  |
| Control valve                             | Normally open         |
| Operation mode                            | digital vacuum switch |

SMP 20 NO AS VD

Compact ejector SCP is delivered as a ready to connect product (without connection cable).

Available spare parts: silencer box, filter element

Available accessories: connection cable, connection plug

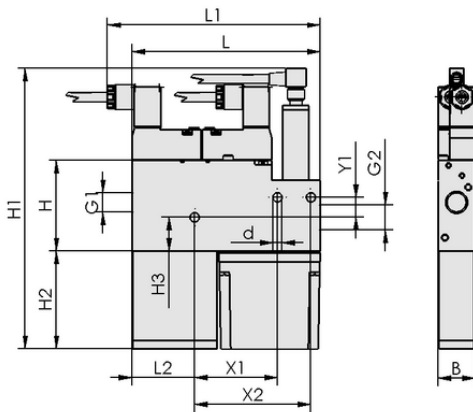

Design data SMP 20 NO AS VD

**Design data**

| Attribute           | Value     |
|---------------------|-----------|
| Length L2           | 37.50 mm  |
| Length L            | 112.50 mm |
| Width B             | 22.00 mm  |
| Height H1           | 181.50 mm |
| Height H2           | 58.50 mm  |
| Height H            | 54.00 mm  |
| Internal diameter d | 5.50 mm   |
| Thread G1           | G1/4"-F   |
| Thread G2           | G3/8"-F   |
| Height H3           | 20.10 mm  |
| Hole spacing Y1     | 12.0 mm   |
| Hole spacing X1     | 49.5 mm   |
| Hole spacing X2     | 69.5 mm   |

# Compact ejector

## SMP 20 NO AS VD



Art.-Nr.: 10.02.02.00577



### Technical data

| Attribute            | Value         |
|----------------------|---------------|
| Nozzle diameter      | 2.0 mm        |
| Degree of evacuation | 85.0 %        |
| Suction rate (max.)  | 4.096 cfm     |
| Product family       | SMP           |
| Control valve        | Normally open |

Note: The supply voltage for vacuum switches and solenoid valves is 24V DC Air consumption: At optimal operating pressure Hose diameter: For max. length 2 m



### Further documentation

CAD data and other documents relating to the article can be found at: [www.schmalz.com/10.02.02.00577](http://www.schmalz.com/10.02.02.00577)



### Ordering Data Accessories 10.02.02.00577

| Typ              |                             | Item number    |
|------------------|-----------------------------|----------------|
| Connection cable | ASK B-Form-C 5000 K-3P      | 21.04.06.00084 |
| Connection cable | ASK B-M8-4 5000 K-4P        | 10.06.02.00031 |
| Connection cable | ASK WB-M8-4 5000 K-4P       | 10.06.02.00032 |
| Connection cable | ASK 10000 K-3P              | 21.04.06.00118 |
| Connection plug  | ASS B-C SK                  | 21.04.06.00085 |
| Distributor      | ASV-IR SMP/SCP-20-30-NO 500 | 10.02.02.01684 |



### Ordering Data Spare Parts 10.02.02.00577

| Typ                    |                                   | Item number    |
|------------------------|-----------------------------------|----------------|
| Filter insert (round)  | FILT-EINS 50 14x49 PE-POR SCP-SMP | 10.02.02.00654 |
| Silencer (cube-shaped) | SD 50.5x21x53.5 SMP15/20          | 10.02.02.00651 |



[WWW.SCHMALZ.COM/10.02.02.00577](http://WWW.SCHMALZ.COM/10.02.02.00577)