

Bellows suction cup (round)

FG 19 HT1-60 N047



Art.-Nr.: 10.01.06.02611



FG 19 HT1-60 N047

Technical data

Attribute	Value
Suction cup material	High temperature material HT1
Material hardness [Shore A]	60.0 Shore A
Size	19.00
Number of folds	2.5

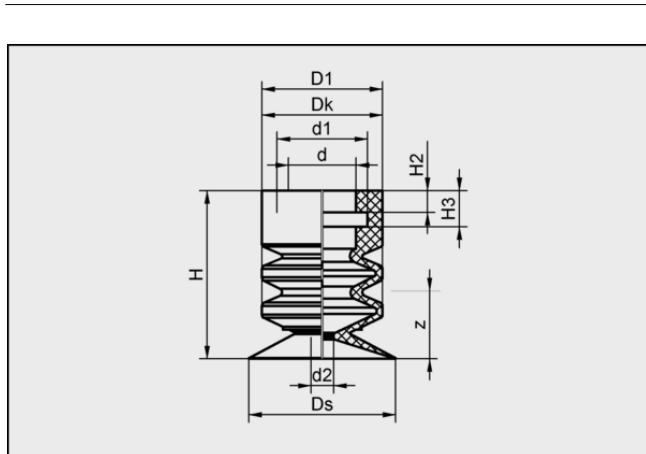

Design data FG 19 HT1-60 N047

Design data

Attribute	Value
Height H2	2.90 mm
Height H	22.30 mm
Outside diameter D1	16.0 mm
Head diameter Dk	16.0 mm
Internal diameter d1	12.0 mm
d2	3.0 mm
Internal diameter d	9.00 mm
Spring stroke Z	6.0 mm
Diameter Ds	19.5 mm
Height H3	4.80 mm
Diameter Dmax(S)	20.7 mm

Note: Acceptable dimensional tolerances for elastomer parts concerning to DIN ISO 3302-1 M3



WWW.SCHMALZ.COM/10.01.06.02611

Art.-Nr.: 10.01.06.02611

**Technical data**

Attribute	Value
Nipple family	N 047
Suction cup material	High temperature material HT1
Material hardness [Shore A]	60.0 Shore A
Hose inner diameter (recom.) d	4.0 mm
Workpiece radius min. (convex)	25.0 mm
Pull-off force	12.50 N
Suction force (-600mbar)	2.60 N
Weight	2.30 g
Volume	1.450 cm ³
Size	19.00
Number of folds	2.5
Product family	FG

Note: Suction force: The suction force values are theoretical values at -0.6 bar vacuum and a dry, smooth and even workpiece surface – they are specified without safety factors. Hose inner diameter: The recommended hose diameter refers to a hose length of approx. 2 m

**Further documentation**

CAD data and other documents relating to the article can be found at: www.schmalz.com/10.01.06.02611

**Ordering Data Accessories 10.01.06.02611**

Typ		Item number
Suction Cup Connection Nipples	SA-NIP N047 G1/8-AG DN350	10.01.01.12491

